



PM ESTATES

Property Sales & Lettings



Navigation House

Bishops Stortford, Hertfordshire, CM23 3AS

£895.00_{pcm}

Navigation House

Bishops Stortford, Hertfordshire, CM23 3AS

Overview

- Stunning south facing town and river views
- Third floor one-bedroom apartment
- Family size bathroom
- Open plan living area
- Fully fitted kitchen
- Large feature picture style window
- Ample storage cupboards
- Offered furnished
- Walking distance to mainline rail station
- Town centre location
- Energy rating B
- Council Tax band B



Description

Located in the heart of Bishops Stortford Town Centre, within walking distance of various bars, shops, restaurants and directly above a popular 24-hour gym, this modern one-bedroom apartment is offered furnished.

The property is larger than average and includes two storage cupboards in the hallway which leads in to a large and open plan living area. This social area promotes modern living and has a large feature window offering south facing and direct river and town centre views. Complete with a fully fitted kitchen and family size bathroom, this apartment is ideal for single professionals and couples alike who wants to take advantage of the town's best features.

Navigation House is a four-minute walk from the mainline rail station which offers direct services to London Liverpool Street, Cambridge and Stansted Airport.



Energy Efficiency Rating			Environmental Impact (CO ₂) Rating		
	Current	Potential		Current	Potential
Very energy efficient - lower running costs			Very environmentally friendly - lower CO ₂ emissions		
(92-100) A			(92-100) A		
(81-91) B	83	84	(81-91) B		
(69-80) C			(69-80) C	76	77
(55-68) D			(55-68) D		
(39-54) E			(39-54) E		
(21-38) F			(21-38) F		
(1-20) G			(1-20) G		
Not energy efficient - higher running costs			Not environmentally friendly - higher CO ₂ emissions		
England&Wales	EU Directive 2002/91/EC		England&Wales	EU Directive 2002/91/EC	

Ground Floor

Approx. 41.0 sq. metres (441.6 sq. feet)

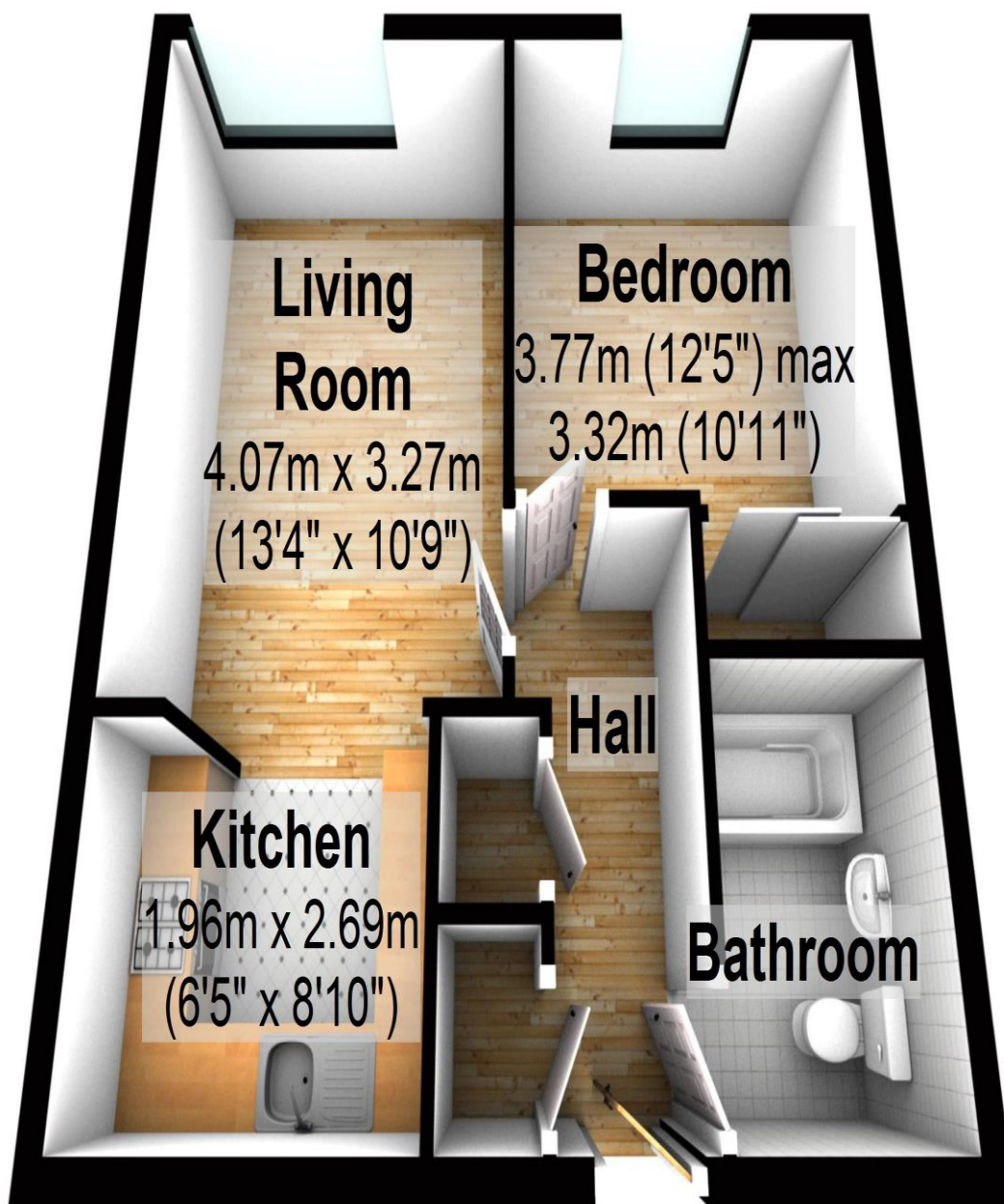

Total area: approx. 41.0 sq. metres (441.6 sq. feet)

7 Riverside Walk, South Street, Bishop's Stortford, Herts CM23 3AG

Tel: 01279 654646

Email: info@pm-estates.co.uk

www.pm-estates.co.uk

PM Estates wish to advise prospective purchasers that we have not checked the services or appliances. The sales particulars have been prepared as a guide only; any floor-plan or map is for illustrative purposes only. PM Estates, for themselves and for the vendors or lessors of this property whose agents they are give notice that: the particulars have been produced in good faith; do not constitute any part of a contract; no person in the employment of PM Estates has any authority to make or give any representation of warranty in relation to this property.

P820